

Bleeder Valves and Plugs

ORDERING INFORMATION

Bleed "T" Valves

PART NO.	CONNECTIONS	BODY & STEM	SEAT	BLEED "T" PLUG
V-597-10	1/2" MNPT x (2) 1/2" FNPT	A108-1215 CS / A479-316 SS	Integral Metal	A108-1215 CS
V-597-C0		A479-316 SS		A479-316 SS
B8-597-10	1/2" MNPT x (3) 1/2" FNPT	A108-1215 CS / A479-316 SS		None
B8-597-C0		A479-316 SS		None
V-598-10	3/4" MNPT x (2) 1/2" FNPT	A108-1215 CS / A479-316 SS		A108-1215 CS
V-598-C0		A479-316 SS		A479-316 SS
B8-598-10	3/4" MNPT x (3) 1/2" FNPT	A108-1215 CS / A479-316 SS	None	
B8-598-C0		A479-316 SS	None	

MAX Cv Rating: .125 **Approximate Weight:** 1.00 lbs [0.45 kg] each
Carbon Steel: 10,000 PSI @ 200°F or 1,500 PSI @ 800°F
316 SS: 10,000 PSI @ 200°F or 1,500 PSI @ 1,000°F

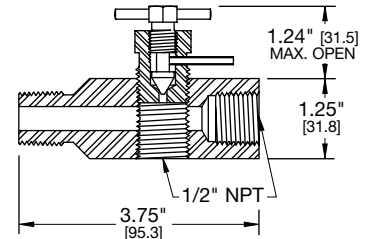

Bleed "T" Plugs B6

PART NO.	CONNECTIONS	BODY & STEM	SEAT
BV10N2-10	1/4" MNPT	ASTM A108-1215 CS / ASTM A479-316 SS	Carbide Ball
BV10N2-C0		ASTM A479-316 SS / ASTM A479-316 SS	
BV10N4-10	1/2" MNPT	ASTM A108-1215 CS / ASTM A479-316 SS	
BV10N4C0		ASTM A479-316 SS / ASTM A479-316 SS	

Approximate Weight: .50 lbs [0.23 kg] each
Carbon Steel: 10,000 PSI @ 200°F or 1,500 PSI @ 500°F
316 SS: 10,000 PSI @ 200°F or 1,500 PSI @ 1,000°F

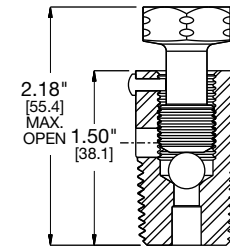

Bleed "T" Plugs B2

PART NO.	CONNECTIONS	BODY & STEM	SEAT
A7-528-10	1/4" MNPT	ASTM A108-1215 CS / ASTM A479-316 SS	410 SS Ball
A7-528-C0		ASTM A479-316 SS / ASTM A479-316 SS	
A7-529-10	1/2" MNPT	ASTM A108-1215 CS / ASTM A479-316 SS	
A7-529-C0		ASTM A479-316 SS / ASTM A479-316 SS	

MAX Cv Rating: .125 **Approximate Weight:** .50 lbs [0.23 kg] each
Carbon Steel: 10,000 PSI @ 200°F or 1,500 PSI @ 500°F
316 SS: 10,000 PSI @ 200°F or 1,500 PSI @ 1,000°F

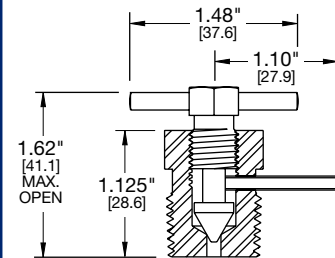

Carbide Ball Bleed Plugs B1

PART NO.	CONNECTIONS	BODY & STEM	SEAT
A7-521-10	1/4" MNPT	ASTM A108-1215 CS / ASTM A479-316 SS	Carbide Ball
A7-521-C0		ASTM A479-316 SS / ASTM A479-316 SS	
A7-520-10	1/2" MNPT	ASTM A108-1215 CS / ASTM A479-316 SS	
A7-520-C0		ASTM A479-316 SS / ASTM A479-316 SS	

Approximate Weight: .50 lbs [0.23 kg] each
Carbon Steel: 10,000 PSI @ 200°F or 1,500 PSI @ 500°F
316 SS: 10,000 PSI @ 200°F or 1,500 PSI @ 1,000°F

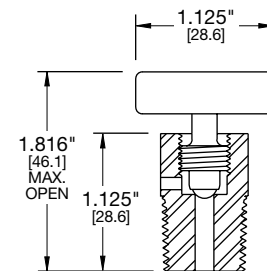

Mini-Hex Bleed Plugs B4

PART NO.	CONNECTIONS	BODY & BLEED SCREW	SEAT
A7-525-10	1/4" MNPT	ASTM A108-1215 CS / 17-4 PH	Integral Metal
A7-525-C0		ASTM A479-316 SS / 17-4 PH	
A7-526-10	1/2" MNPT	ASTM A108-1215 CS / 17-4 PH	
A7-526-C0		ASTM A479-316 SS / 17-4 PH	

Approximate Weight: .30 lbs [0.14 kg] each
Carbon Steel: 10,000 PSI @ 200°F or 1,500 PSI @ 500°F
316 SS: 10,000 PSI @ 200°F or 1,500 PSI @ 1,000°F

