

Spare parts list
AUMA®
 Multi-turn actuators
TR-M30X – TR-M1000X
TIGRON

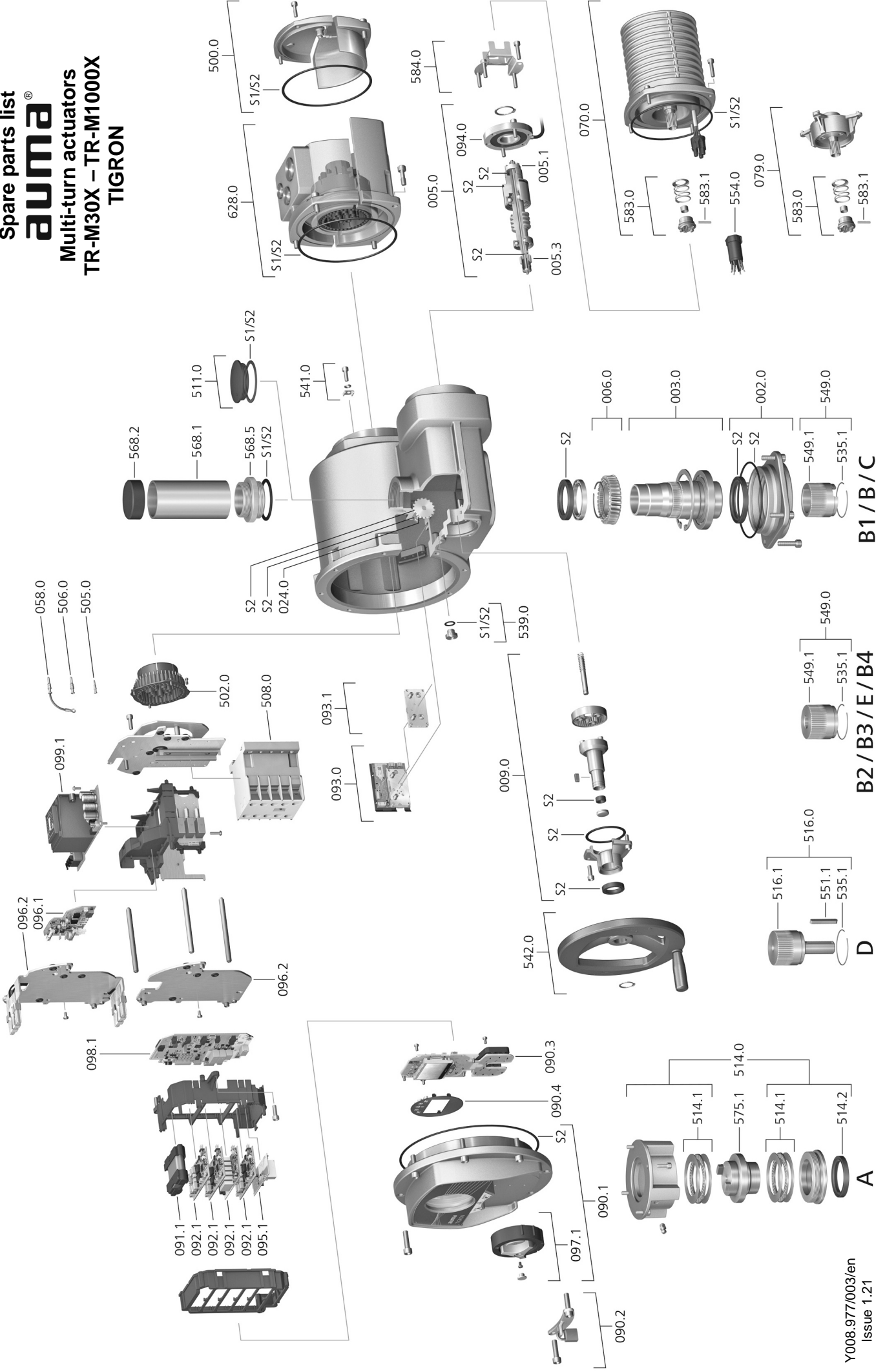

Spare parts list Multi-turn actuators TIGRON

Please state device type and our order number (see name plate) when ordering spare parts. Only original AUMA spare parts should be used. Failure to use original spare parts voids the warranty and exempts AUMA from any liability. Representation of spare parts may slightly vary from actual delivery.

Ref. no.	Designation	Type	Ref. no.	Designation	Type
002.0	Bearing flange	Sub-assembly	502.0	Pin carrier without pins	Sub-assembly
003.0	Hollow shaft	Sub-assembly	505.0	Pin for controls	Sub-assembly
005.0	Drive shaft	Sub-assembly	506.0	Pin for motor	Sub-assembly
005.1	Motor coupling		508.0	Switchgear	
005.3	Manual drive coupling		511.0	Threaded plug	Sub-assembly
006.0	Worm wheel		514.0	Output drive type A (without stem nut)	Sub-assembly
009.0	Manual gearing	Sub-assembly	514.1	Axial needle roller bearing	Sub-assembly
024.0	Travel signal conduit with drive wheel for limit switching	Sub-assembly	514.2	Radial seal for output drive type A	
058.0	Cable for protective earth	Sub-assembly	516.0	Output drive type D	Sub-assembly
070.0	Motor (for V... motors incl. ref. no. 079.0)	Sub-assembly	516.1	Output drive shaft D	
079.0	Planetary gearing for motor drive (only for V... motors)	Sub-assembly	535.1	Snap ring	
090.1	Cover for local controls assy	Sub-assembly	539.0	Screw plug	Sub-assembly
090.2	Locking device assy	Sub-assembly	541.0	External earth connection	Sub-assembly
090.3	Local controls board		542.0	Handwheel with ball handle	Sub-assembly
090.4	Face plate for display		549.0	Output drive types (B1/B2/B3/B4/C/E)	Sub-assembly
091.1	Battery module		549.1	Output drive sleeve (B1/B2/B3/B4/C/E)	
092.1	I/O module, fieldbus module		551.1	Parallel key	
093.0	Position sensing	Sub-assembly	554.0	Socket carrier for motor plug/socket connector with cable harness	Sub-assembly
093.1	Reduction gearing for position sensing for 5,000 turns/stroke (option)	Sub-assembly	568.1	Stem protection tube (without cap)	
094.0	Torque sensor		568.2	Protective cap for stem protection tube	
095.1	TMS tripping device		568.5	Stem protection tube adapter	
096.1	Heater sub-assembly (option)	Sub-assembly	575.1	Stem nut A (without thread)	
096.2	Support plate		583.0	Motor coupling on motor shaft	Sub-assembly
096.2	Support plate for heater (option)		583.1	Pin for motor coupling	
097.1	Combi-Switch assy	Sub-assembly	584.0	Retaining spring for motor coupling	Sub-assembly
098.1	Logic board		628.0	Ex plug/socket connector with terminal connection (KT)	Sub-assembly
099.1	Power supply unit		S1	Seal kit, small	Set
500.0	Cover	Sub-assembly	S2	Seal kit, large	Set