

Direct-Mount[®] Duo[™]

Stabilized Connector with Integral Block Valves for a Safe and Accurate Measurement



Compact Dual Function Design

Parker is the recognized industry leader in the close coupling of manifold systems. The patented Direct-Mount[®] Systems (DMS) were developed in response to requests by leading gas transmission companies for a safe, efficient method of close coupling electronic flow meters and transmitters to orifice fittings. The need for close coupling was established after industry testing proved the existence of flow and/or pulsation-induced Gauge Line Error (GLE) in traditional, remotely tubed meter installations. The research concluded that GLE can be minimized by mounting metering instruments directly to the orifice fitting, using constant diameter large bore manifolding.



Contact Information:

Parker Hannifin Corporation
PGI Division
16101 Vallen Drive
Houston, TX 77041 USA

phone 713 466 0056
fax 800 568 9228
pgi_sales@parker.com

www.pgiint.com
www.parker.com

Product Features:

- Bonnets and roll pins are factory installed and pressure tested to eliminate field-induced leak points
- Less than 10 minutes to install pre-assembled, pre-tested units in the field
- Uninterrupted flow path facilitates accurate gas measurement and minimizes pulsation and square root errors
- Full 3/8" bore
- Features Parker's patented Pressure-Core[®] Stem Seal, a no maintenance and virtually leak-free valve with a 5 year warranty
- Features Turn-Saver[™] technology, an innovative feature that minimizes the number of turns to fully open or close the bonnet, allowing less repetitive motion and saving significant time
- Dielectric Kits available



ENGINEERING YOUR SUCCESS.

Direct-Mount® Duo™

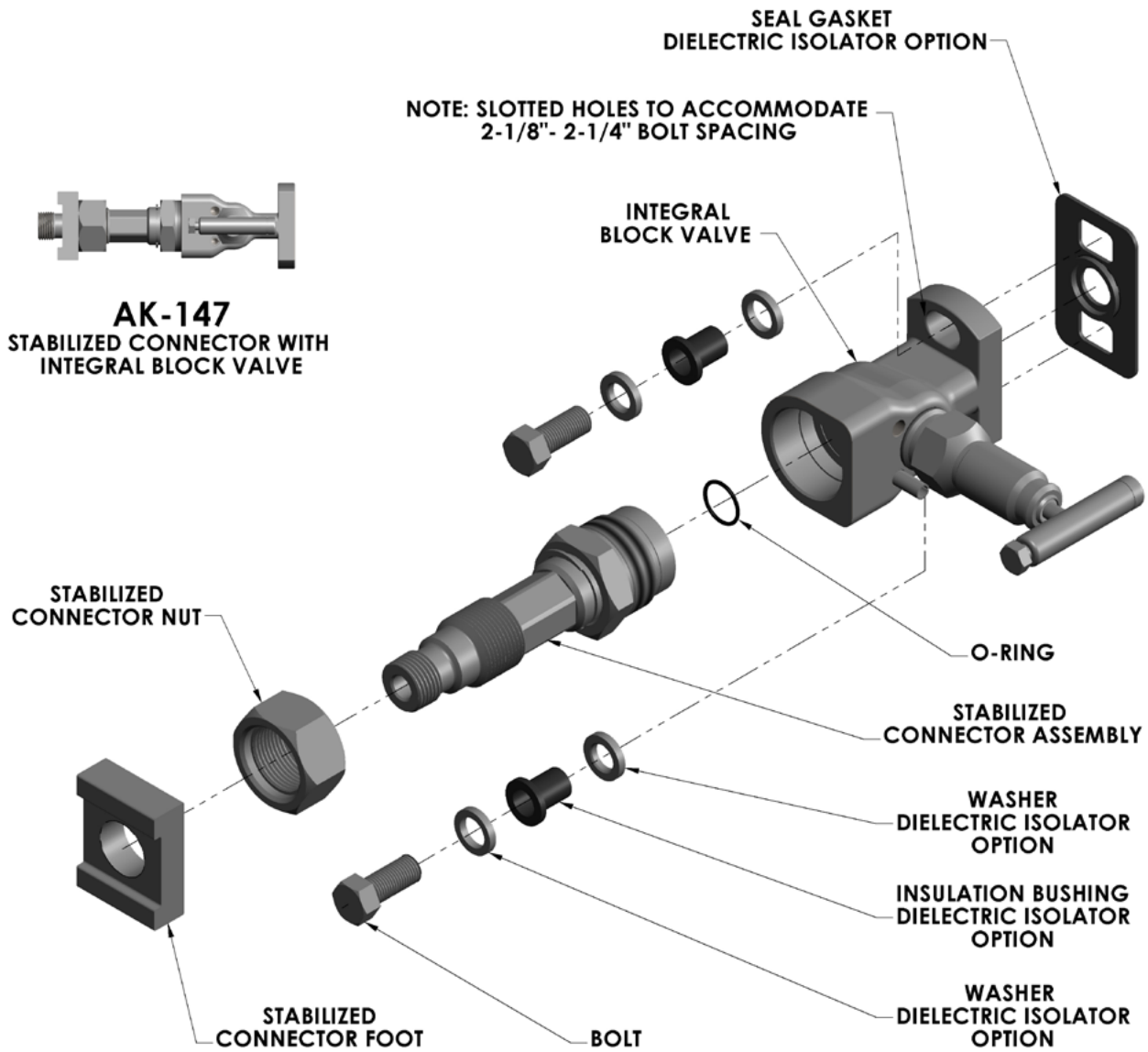

Safety Guide – See www.parker.com/safety.

© 2014 Parker Hannifin Corporation

PGI-DMD Mar 2014



Parker Hannifin Corporation
PGI Division
 16101 Vallen Drive
 Houston, Texas 77041
 phone 713 466 0056
 fax 713 744 9897
www.pgiint.com

Your Local Authorized Parker Distributor