

2162L

SINGLE POINT LOAD CELL " OFF CENTER "

Economical single point load cell specially designed for the weighing of platforms and bunkers.

Model 2162 - 50 kg

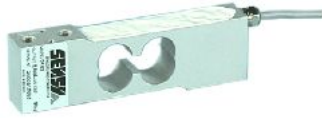

Features

- Designed for off-center load
- Maximum platform size : 400 x 400 mm
- Material : anodized aluminium alloy
- Protection: IP 63
- Competitive price
- Easy to install
- Cable length: 3m
- Weight: 0.35kg
- Available options (non exhaustive list):
 - o protection cover (option F)
 - o ATEX intrinsic safety Ex II 1GD Ex ia IIC T6 or T4 Ga Ex ia IIIC T80 C Da
 - o high service temperature (up to 150 C)

Applications

The SENSY's load cell 2162L is perfectly designed to the following applications :

- Single point load cells for industrial scales and weighing system
- Weighing of small bunker
- Filling, packaging and batching applications

Capacities

2162L : 10 - 15 - 20 - (30) - 50 - 75 - (100) - (150) kg

Specifications	A3	
Accuracy class	3000 d *	-
Combined error	< ± 0.03	% F.S.
Linearity error	< ± 0.025	% F.S.
Repeatability error	< ± 0.015	% F.S.
Creep error over 30 min.	< ± 0.03	% F.S.
Zero shift after loading	< ± 0.0075	% F.S.
Reference temperature	23	C
Nominal temperature range	-10...+45	C
Service temperature range	-30...+70	C
Storage temperature range	-50...+85	C
Temperature coefficient of the sensitivity	< ± 0.1	% F.S./10 C
Temperature coefficient of zero signal	< ± 0.05	% F.S./10 C
Zero balance	± 0.02	mV/V
Sensitivity tolerance	< ± 0.2	%
Input resistance	352 ± 2	Ohm
Output resistance	352 ± 2	Ohm
Insulation resistance (50V)	> 5000	Megaohm
Reference excitation voltage	10	VDC
Nominal range of excitation voltage	3..12	VDC
Nominal sensitivity	2 ± 10%	mV/V
Safe load limit	150	% F.S.
Breaking load	>300	% F.S.
Static lateral force limit	100	% F.S.
Permissible dynamic loading	60	% F.S.

F.S.: full scale - Specifications subject to change without notice

LOAD CELL

model 2162L aluminium alloy



ATEX CERTIFIED

OFF-CENTER

Range 10–75 kg (100–150 kg) IP63

Cable length : 2 m

Weight : 0.35 kg

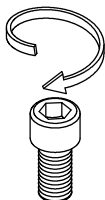
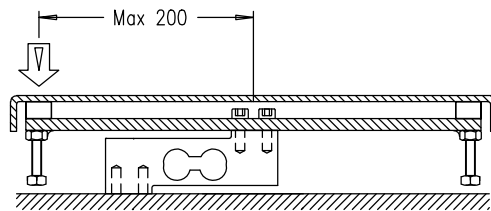
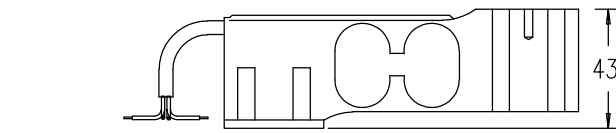
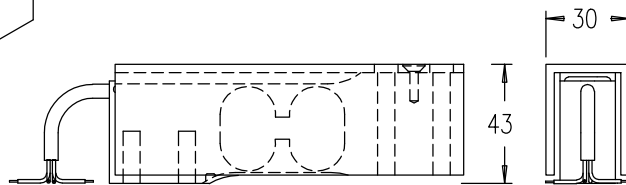
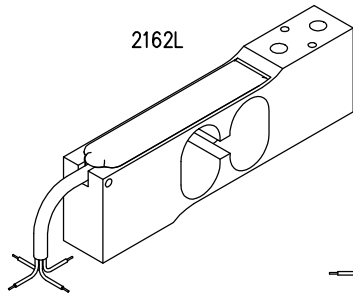
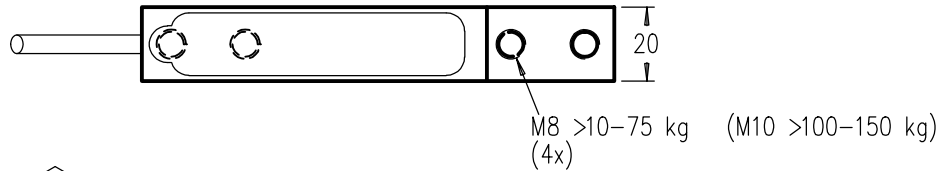
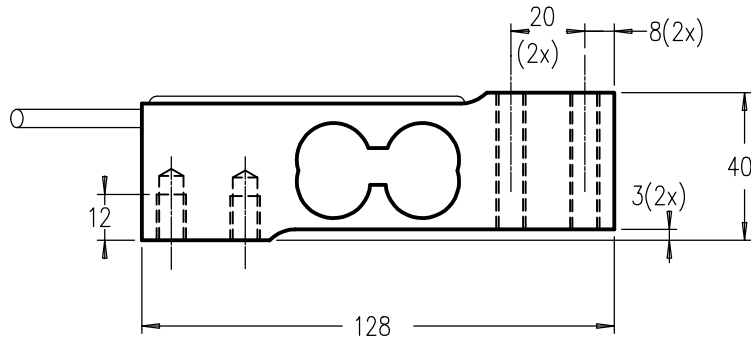
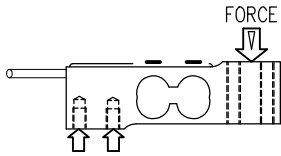

Note: Correct torque for fixing bolts : 10 Nm if M8 50 Nm if M10
(don't touch bottom of tapped holes)