

Slide valves

Types 4160/4165

Slide valves Type 4160 (normally closed) and 4165 (normally open) are manifold mounted, pilot-operated, three port, two position valves with a spring-return action. A major feature of the valve design is elimination of the continuous internal leakage which is characteristic of conventional lapped-face spool valves. The valves each incorporate special high pressure seals which prevent leakage and so render the valves suitable for use with many fluid media.

The valve slide (which can be supplied either normally closed or normally open) has a 'block before bleed' action. In a normally closed valve, for example, this means that the tank port is isolated before pressure and service ports are interconnected.

Construction materials, predominantly 316 stainless steel and CA104 aluminium bronze with seals of fluoroelastomers and PTFE materials, ensure high corrosion resistance and comply with NACE Standard MR-01-75 (latest revision as applicable).

Operating parameters

Working pressure	690 bar (10,000 psi) max.
Pilot pressure	3.4 to 17.2 bar (50 to 250 psi).
Operating media – main slide	Mineral oils, water, water-glycol mixtures.
Operating media – pilot section	Air, or any of the main slide media (above).
Recommended filtration	25 micron.
Connections – pilot	1/4" NPTF
Flow rate, nominal	54 litres/min (12 imp galls/min).
Working temperature	-20°C to + 130°C.



These slide valves conform to Directive 94/9/EC relating to equipment intended for use in potentially explosive atmospheres and is ATEX (ATmosphere EXplosible) certified.



Marshalsea Hydraulics has been assessed by SGS Société Générale de Surveillance SA and certified as meeting the requirements of ISO 9001:2000 for the design, development, manufacture and servicing of hydraulic pumps, relief valves and intensifiers.

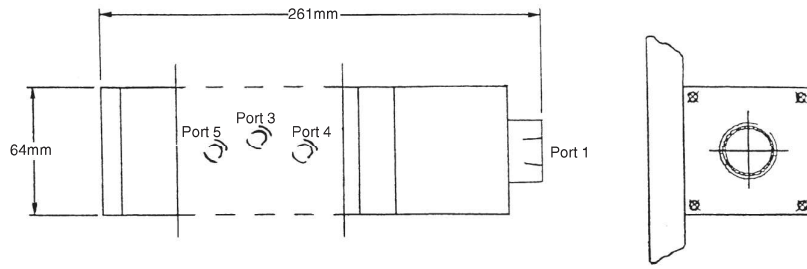

Drawing giving dimensions

Port	Valve 4160	Valve 4165
Port 1	Pilot	Pilot
Port 3	Service	Service
Port 4	Supply	Tank
Port 5	Tank	Supply

Port assignments



Marshalsea Hydraulics Limited
 Marshalsea House
 Venture Way
 Priorswood Industrial Estate
 Taunton
 Somerset TA2 8DE
 United Kingdom

Tel: 01823 331081
 (+44 1823 331081)
 Fax: 01823 323382
 (+44 1823 323382)

E-mail info@marshalsea.co.uk

www.marshalsea.co.uk