

General purpose accelerometer with internal temperature sensor 787T

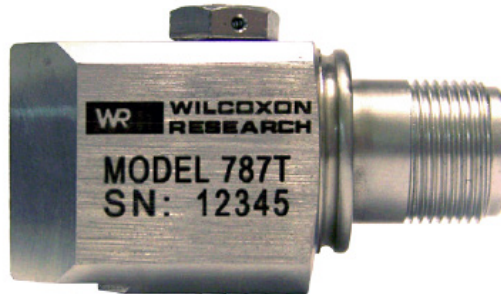

Key features

- Measures both acceleration and temperature
- Rugged design
- Corrosion resistant
- Hermetically sealed
- Case isolated
- ESD protection
- Reverse wiring protection

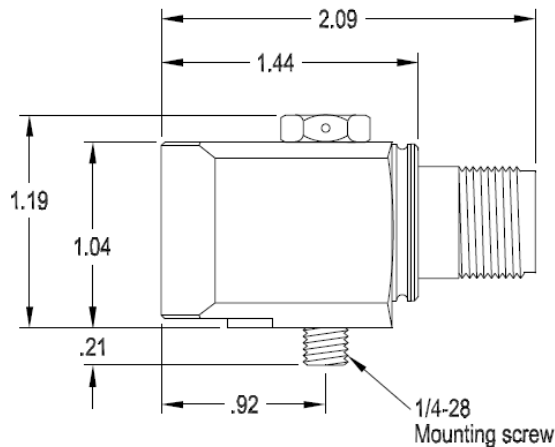
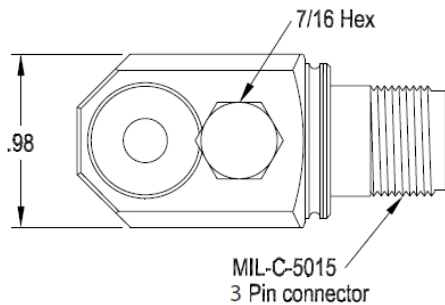

Certifications



Connections	
Function	Connector pin
accelerometer power / signal	A
accelerometer and temp sensor common	B
temperature sensor signal	C
ground	shell

Note: Due to continuous process improvement, specifications are subject to change without notice. This document is cleared for public release.

Wilcoxon Sensing Technologies
 20511 Seneca Meadows Parkway
 Germantown, MD 20876
 info@wilcoxon.com

Tel: (301) 330 8811
 Fax: (301) 330 8873
 www.wilcoxon.com

Wilcoxon Sensing Technologies
 An Amphenol Company

General purpose accelerometer with internal temperature sensor 787T

SPECIFICATIONS

Sensitivity, $\pm 5\%$, 25° C	100 mV/g
Acceleration range, VDC > 25V	80 g peak
Amplitude nonlinearity	1%
Frequency response:	
$\pm 5\%$	1.0 - 5,000 Hz
$\pm 10\%$	0.7 - 10,000 Hz
± 3 dB	0.5 - 12,000 Hz
Resonance frequency	22 kHz
Transverse sensitivity, max	5% of axial
Temperature response:	
-25° C	-10%
+120° C	+10%
Temperature sensor:	
Output sensitivity	10 mV/°C
Measurement range	2 to 120°C
Voltage source ¹	18 - 30 VDC
Current regulating diode ^{1,2}	2 - 10 mA
Electrical noise, equiv g, nominal:	
Broadband 2.5 Hz to 25 kHz	700 μ g
Spectral 10 Hz	10 μ g/ \sqrt Hz
100 Hz	5 μ g/ \sqrt Hz
1000 Hz	5 μ g/ \sqrt Hz
Output impedance, max	100 Ω
Bias output voltage, nominal	12 VDC
Grounding	case isolated, internally shielded
Temperature range	-50 to +120° C
Vibration limit	500 g peak
Shock limit	5,000 g peak
Electromagnetic sensitivity, equiv g, max	70 μ g/gauss
Sealing	hermetic
Base strain sensitivity, max	0.002 g/ μ strain
Sensing element design	PZT ceramic / shear
Weight	145 grams
Case material	316L stainless steel
Mounting	1/4-28 captive screw with 0.046" diameter safety wire hole
Output connector	3 pin, MIL-C-5015 style
Mating connector	3 socket, MIL-C-5015 style
Recommended cabling	3 conductor, shielded

Note: Due to continuous process improvement, specifications are subject to change without notice. This document is cleared for public release.

Wilcoxon Sensing Technologies
20511 Seneca Meadows Parkway
Germantown, MD 20876
info@wilcoxon.com

Tel: (301) 330 8811
Fax: (301) 330 8873
www.wilcoxon.com

Contact

Wilcoxon Sensing
Technologies

20511 Seneca Meadows Parkway
Germantown MD 20876, USA

Tel: +1 301 330 8811
Fax: +1 301 330 8873

info@wilcoxon.com

www.wilcoxon.com

Accessories supplied:

- 1/4-28 captive screw (optional M6 captive screw)

Notes: ¹ To minimize the possibility of signal distortion during high vibration signals, 24 to 28 VDC powering is recommended. The higher level constant current source should be used when driving long cables (please consult customer service).

² A maximum current of 6 mA is recommended for operating temperatures in excess of 100 °C.